

ASSEMBLY & INSTALLATION INSTRUCTIONS

Nest Semi-Flush 128720

A580

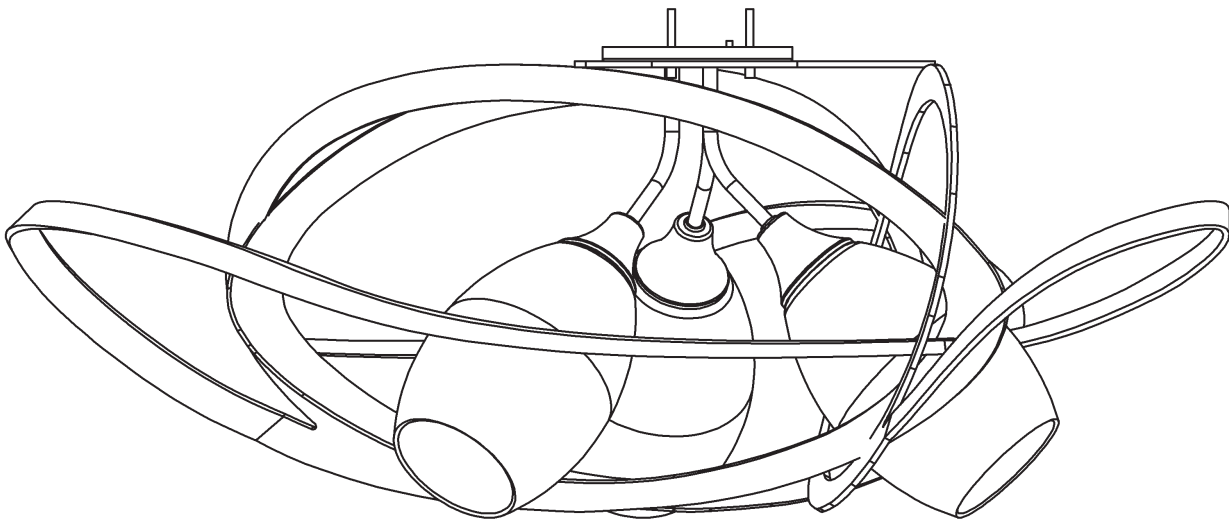

Component Parts

- A Fixture**
- B Crossbar**
- C Threaded Stud (3)**
- D Ground Screw**
- E Safety Cable**
- F Knob (3)**
- G Glass (3)**
- H Retaining Ring (3)**
- I Socket (3)**



ASSEMBLY & INSTALLATION INSTRUCTIONS

A580

Nest Semi-Flush 128720

CAUTION: FAILURE TO INSTALL THIS FIXTURE PROPERLY MAY RESULT IN SERIOUS PERSONAL INJURY OR DEATH AND PROPERTY DAMAGE. We recommend installation by a licensed electrician. This product must be installed in accordance with applicable installation code(s), by a person familiar with the construction and operation of the product and the hazards involved.*

Caution: Do not exceed maximum wattage noted on fixture. Use only recommended bulbs with fixture.

Please Note: After installation extra hardware and accessories are possible; our kits are used on multiple products.

To Install Fixture (Figure 1)

CAUTION: BE SURE POWER IS OFF AT THE MAIN BREAKER BOX PRIOR TO INSTALLATION.

1. Carefully unpack fixture (A) from the carton.
2. Thread the threaded studs (C) into the crossbar (B) in the locations that line up with the holes in fixture.

3. Using two machine screws (not provided), fasten the crossbar (B) to the electric box.

Note: A new electric box comes with screws. When replacing a fixture, retain the existing screws for use with the new fixture.

4. Attach safety cable (E) to crossbar (B) using ground screw (D). The weight of the fixture can now be supported by safety cable (E).

Note: The safety cable also acts as a ground wire for the fixture.

5. Using suitable wire connectors (not provided) connect fixture wires to supply (white to white and black to black). Connect all ground wires (bare copper or green to bare copper or green). Push wires back into electrical box.

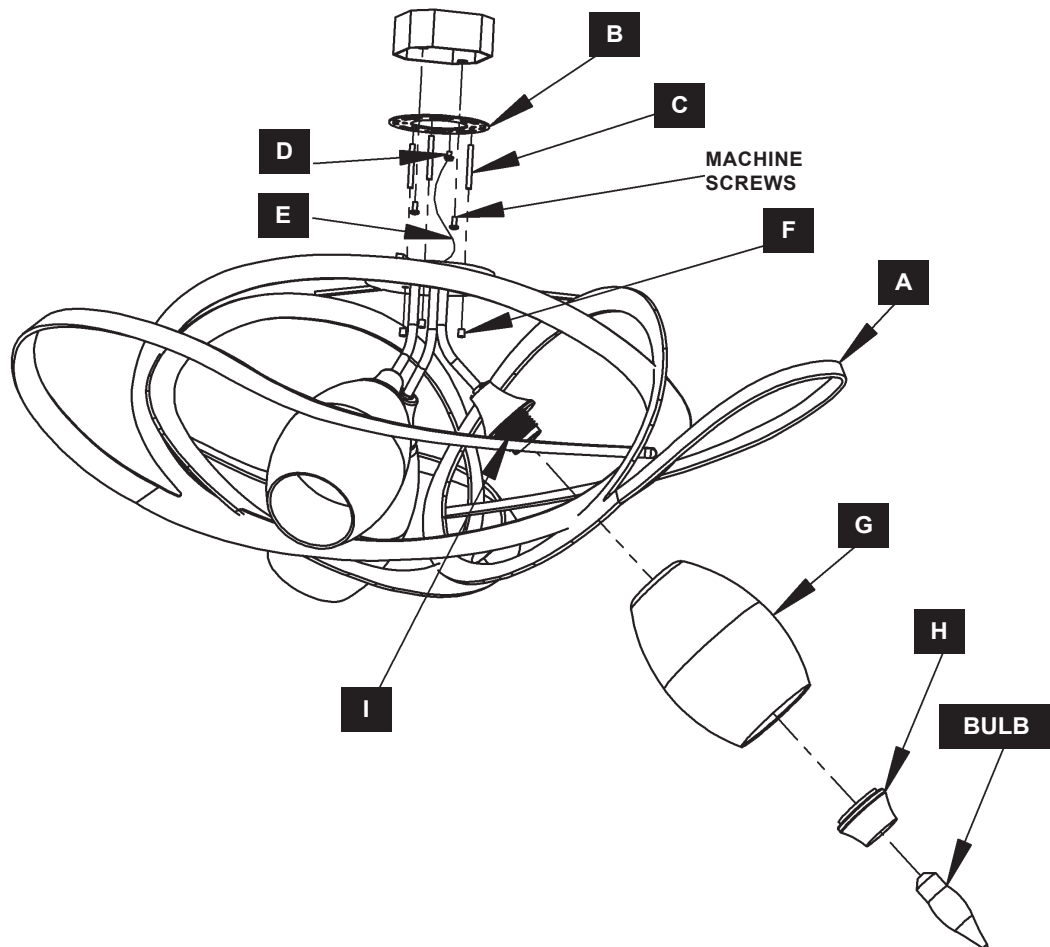

CAUTION: MAKE SURE WIRE CONNECTORS ARE TWISTED ON SECURELY AND NO BARE WIRE IS EXPOSED.

ASSEMBLY & INSTALLATION INSTRUCTIONS

A580

Nest Semi-Flush 128720

6. Push fixture (A) against ceiling and secure with knobs (F). Be sure threaded studs (C) are fully seated in knobs.

CAUTION: BE SURE NO WIRES ARE PINCHED BETWEEN THE CANOPY AND THE CEILING.

7. Retaining ring (H) comes pre-installed on fixture, remove retaining ring from socket (I).
8. Install glass (G) onto socket (I) and secure with retaining ring (H). Do not over tighten the retaining ring.
9. Install bulb into socket.
10. Repeat for remaining sockets.
11. Restore electricity at the main breaker.

If you need further assistance, or find that you are missing any parts, please contact the dealer from which you purchased this product. We hope you enjoy your fixture!

**** Hubbardton Forge will not be liable for injury or damage caused by improper installation, lamping or use of this fixture.***