

Glass Installation Instructions

A62

For Exos Style Fixtures

Please refer to installation instructions and install fixture before installing glass.

Component Parts

- A Glass
- B Frame Assembly
- C Retaining Ring
- D Diffuser Glass (if applicable)

To Install Glass

1. Place Glass (A) into Frame Assembly (B).
2. Place Frame Assembly with Glass over the threaded fixture socket and secure with Retaining Ring (C).
3. Install light bulb, making sure not to exceed the maximum wattage marked on the fixture.
4. For fixtures using Diffuser Glass (D), insert the diffuser up into the fixture at an angle then level it and gently lower onto the lowest tabs of the frame.

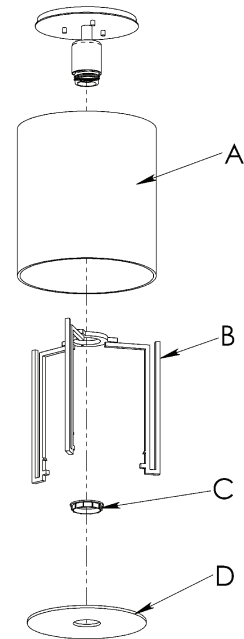

This illustration represents a typical fixture and may not match every style.

If you need further assistance, or find that you are missing any parts, please contact the dealer from which you purchased this product. We hope you enjoy your fixture!