

Assembly & Installation Instructions

A340

For Circular New Town Ten Light 103290

Page 1 of 2

CAUTION: FAILURE TO INSTALL THIS FIXTURE PROPERLY MAY RESULT IN SERIOUS PERSONAL INJURY OR DEATH AND PROPERTY DAMAGE. We recommend installation by a licensed electrician. This product must be installed in accordance with applicable installation code(s), by a person familiar with the construction and operation of the product and the hazards involved.*

Caution: Do not exceed maximum wattage noted on fixture. Use only recommended bulbs with fixture.

Install the Canopy (Figure 1)

Component Parts

A Crossbar	G Threaded Loop
B Threaded Nipple	H Chain
C Lag Screw (2)	I Fixture Loop
D Lock Nut	J Ground Screw
E Canopy	K Cupped Washer
F Loop Collar	L Hex Nut

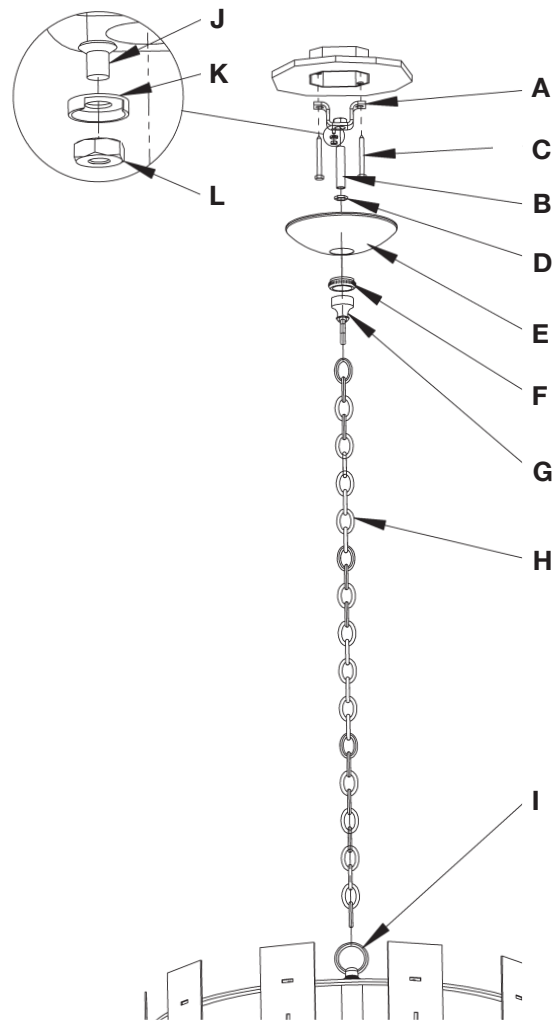

CAUTION: BE SURE POWER IS OFF AT THE MAIN BREAKER BOX PRIOR TO INSTALLATION.

CAUTION: THIS FIXTURE MUST BE SUPPORTED INDEPENDENTLY OF AN OUTLET BOX. CROSSBAR IS DESIGNED TO FIT IN THE BOTTOM OF A STANDARD METAL 4" OCTAGONAL OUTLET BOX.

1. Drill two holes through the back of the outlet box and using two lag screws (C) attach cross bar (A) to a structural member in the ceiling, centering the crossbar in the outlet box. We've supplied lag screws with your fixture; however, different materials and/or construction methods may require different fasteners. If in doubt, contact a qualified electrician.
2. Unthread Loop Collar (F) from Threaded loop (G). Thread lock nut (D) and threaded loop (G) onto nipple, then place canopy (E) over threaded loop and adjust nipple length to ensure a snug canopy fit. Once the length is determined, set the canopy aside and lock nipple position by tightening the locknut (D) against the crossbar (A).
3. Attach one end of the chain (H) to the fixture loop (I).
4. Slide Loop Collar (F) and Canopy (E) over chain.
5. Attach the other end of the chain to the threaded loop (G). Thread the fixture wires through every other link of the chain (H) and up through the threaded loop (G) and nipple (B) into the outlet box.

(Figure 1)

If you need further assistance, or find that you are missing any parts, please contact the dealer from which you purchased this product. We hope you enjoy your fixture!

* Hubbardton Forge will not be liable for injury or damage caused by improper installation, lamping or use of this fixture.

Assembly & Installation Instructions

A340

For Circular New Town Ten Light 103290

Page 2 of 2

Install the Canopy (Figure 1)

(Continued)

- Using suitable wire connectors (not provided), connect fixture wires to supply wires (white or ribbed side of fixture cord to white supply, black or smooth side of fixture cord to black supply). Ground the crossbar (A) using the ground screw (J), cupped washer (K) and hex nut (L) to secure a pigtail lead to the crossbar. Connect all ground wires (bare copper or green to bare copper or green). Push wires back into outlet box.

CAUTION: MAKE SURE WIRE CONNECTORS ARE TWISTED ON SECURELY, AND NO BARE WIRE IS EXPOSED.

- Slide the canopy up the chain and over the threaded loop (G), securing with loop collar (F). Make sure no wires are pinched between the canopy (E) and the ceiling or crossbar (A).

To Install Glass (Figure 2)

Component Parts

- M Fixture
- N Screw (10)
- O Glass Ring (10)
- P Glass (10)

- Install light bulbs (not provided).
- Slip glass ring (O) over glass (P) making sure the counter sunk side is facing up. Install glass (P) aligning glass ring (O) hole with threaded hole in fixture (M).
- Install screw (N) to attach glass ring (O) to fixture (M).
- Repeat steps two & three until all ten glass pieces are installed.
- Restore electricity at the main breaker.

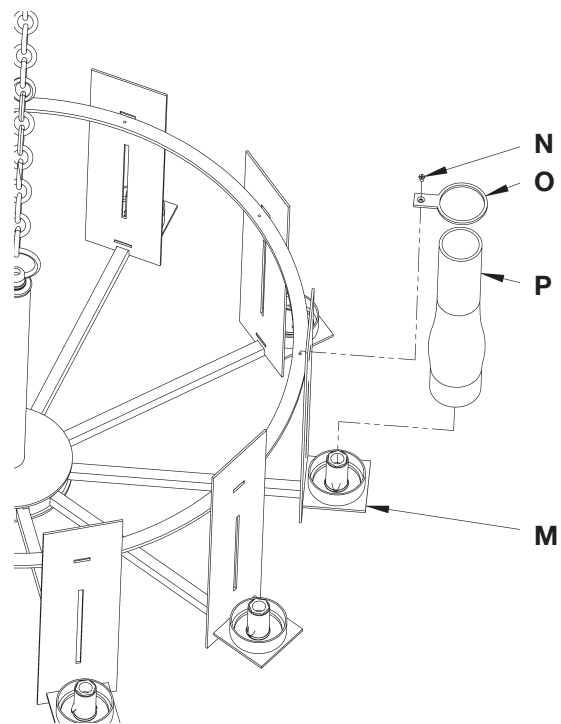

(Figure 2)

If you need further assistance, or find that you are missing any parts, please contact the dealer from which you purchased this product. We hope you enjoy your fixture!

*Hubbardton Forge will not be liable for injury or damage caused by improper installation, lamping or use of this fixture.